

## HECTOR — VINCENT VAN DUYSSEN 2020

1—  
9



Modular, modern and flexible, the Hector system is designed to create aerial and dynamic compositions with elements exploiting the characteristics of mounting brackets secured between floor and ceiling or to the wall. The many combinations of possible finishes offer compositions that differ in terms of visual impact and attractive shapes, transforming Hector from a modern Hi-Tech bookcase into a traditional bookcase.

### DATASHEET

REGISTERED  
DESIGN

2026

FINISHES

finishes	slate	bronze/ pewter colour/ iris	matt lacquered	black oak	sunrise oak/ coffee oak	extra-clear transparent glass	smoked glass	bonded hide leather	Frame slate bronze pewter colour iris	Matt lacquer insert black bronze pewter colour iris
components										
ceiling/wall mounting bracket	•	•		•*	•**					
shelves										
frame	•	•		•*	•**					
insert			•▲	•	•	•	•			
containers				•*	•**					
inner insert lower flap door								•		

- \* The feet of the mounting brackets and the connections of the shelves and containers in black oak are always in a slate finish.
- \*\* The feet of the mounting brackets and the connections of the containers in sunrise oak are always in the same finish as the shelf frames with which they are combined in the composition.
- ▲ Inserts are always made to match the frame:

TECHNICAL INFORMATION

UPRIGHT  
Extruded aluminium, painted or anodised and covered with wood veneer.

SHELF FRAME  
- Painted aluminium, made up of moulded die cast parts and extruded parts.  
- Solid wood.

SHELF INSERTS  
- Extra-clear or smoky tempered glass.  
- Medium-density fibreboard panel covered with wood veneer or melamine and painted in the colours of the range.

UNIT WITH FLAP DOOR  
Chipboard panel covered in wood veneer.  
The flap door interior is available with an insert in bonded hide leather in the colours of the range.

DECODER UNIT  
Chipboard panel covered in wood veneer.

TV STAND  
Support in phenolic plywood with metal parts for mounting on the uprights.

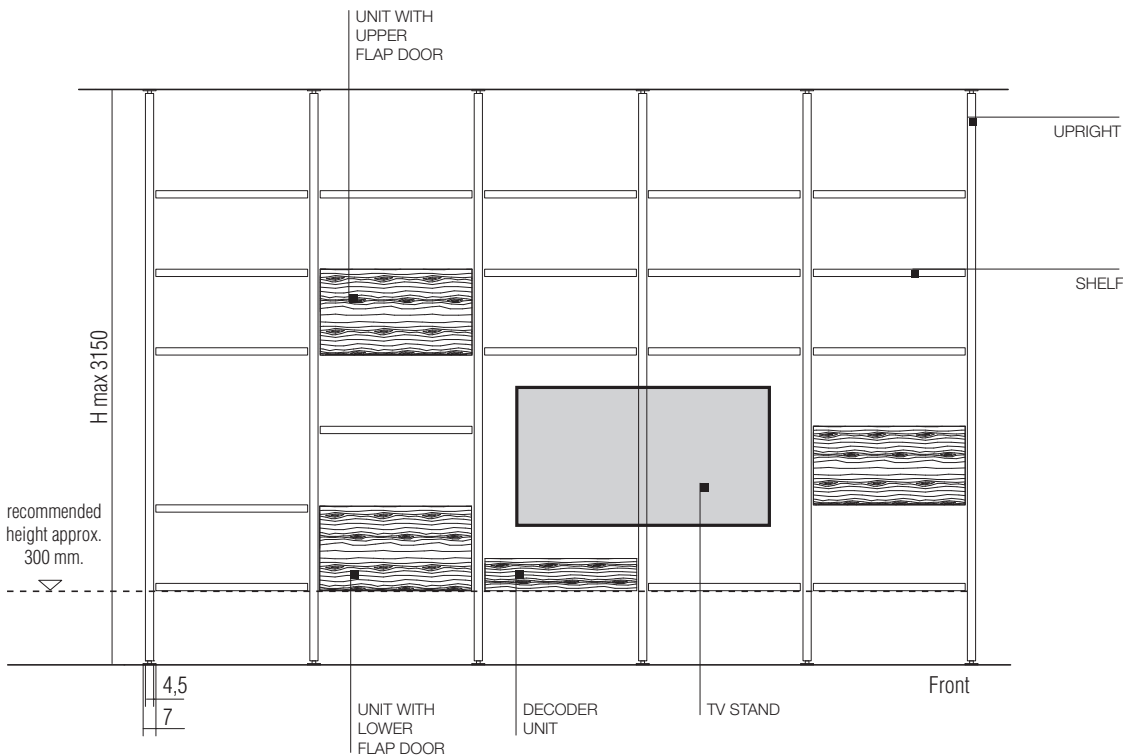

DATASHEET

REGISTERED  
DESIGN  
2026

## NOTES

- The mounting bracket, H max 315, can be made to measure, at no extra cost.
- The depth of the bookcase cannot be reduced.
- The shelf with a solid black oak frame is not available with LED lighting, or in W 113,1 cm.
- The shelf with a solid black oak frame and containers cannot be reduced in any way.
- Shelves with frames in slate, pewter colour, bronze and iris can be reduced in width at a supplementary cost each.

Minimum reduced shelf measurement 30 cm (centre distance).

- The height positioning of the shelves and containers is at the customer's discretion.
- The positioning of the mounting brackets cannot be changed.
- The system involves anchoring the mounting brackets to the floor and ceiling.
- The unit with lower flap door is available with the door interior in bonded hide leather in Molteni range colours.

**The flap door cannot be considered a worktop, but only a surface on which to place lightweight materials.**

- The storage units only come with W 83,1 cm.

## Compositional ceiling fixing diagram

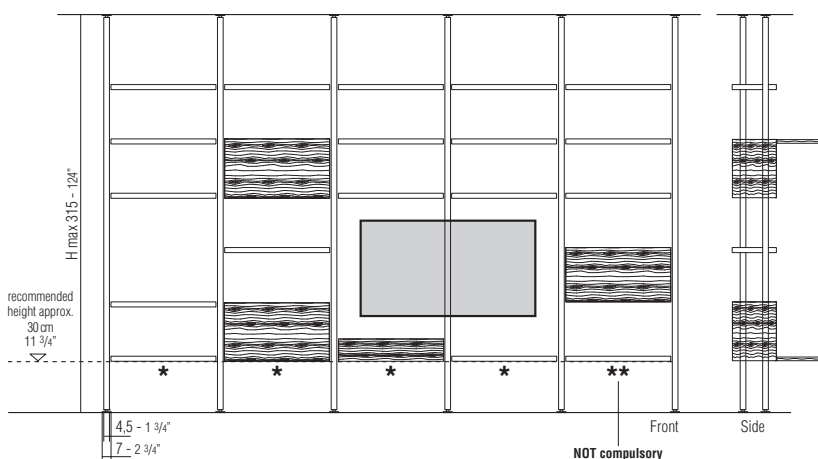

- ★ Compositions with lighting are required to have each module approximately 30 cm above the ground:
    - One shelf with aluminium frame and wood insert (wood or lacquered).
    - Or a decoder unit, a drawer unit or a unit with lower flap door.
- All these elements must be aligned as they are required for the electrical connection.

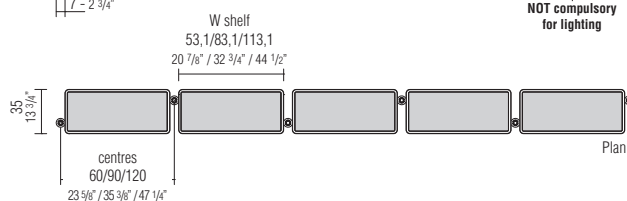

## Mounting bracket positioning

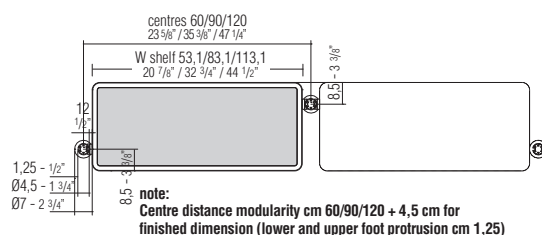
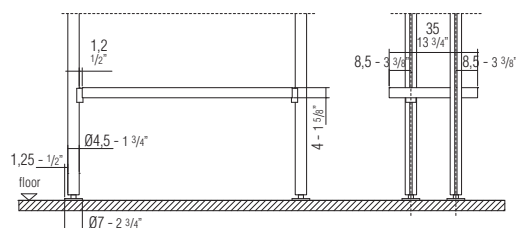
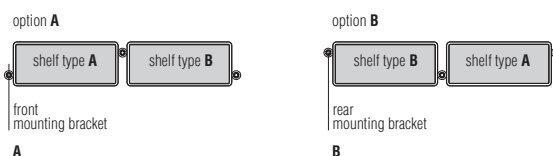

**note:**  
For the construction of the ceiling mounting brackets it is necessary and sufficient to communicate the height of the room. In the case of unaligned dimensions, check the tolerances indicated below.

## Ceiling fixing tolerances

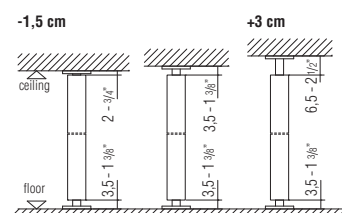

## Shelf capacity with aluminium frame:

W 53,1 = Kg. 15

W 83,1 = Kg. 23

W 113,1 = Kg. 27

## Shelf capacity with solid wood frame:

W 53,1 = Kg. 9

W 83,1 = Kg. 15

Flap door capacity = kg. 4

Container interior capacity = kg. 8

Unit surface capacity = Kg. 15

## DATASHEET

REGISTERED  
DESIGN

2026

## NOTES

- ▶ The mounting bracket, H max 315, can be made to measure, at no extra cost.
- ▶ The depth of the bookcase cannot be reduced.
- ▶ The shelf with a solid black oak frame is not available with LED lighting, or in W 113,1 cm.
- ▶ The shelf with a solid black oak frame and containers cannot be reduced in any way.
- ▶ Shelves with frames in slate, pewter colour, bronze and iris can be reduced in width at a supplementary cost each.

Minimum reduced shelf measurement 30 cm (centre distance).

- ▶ The height positioning of the shelves and containers is at the customer's discretion.
- ▶ The positioning of the mounting brackets cannot be changed.
- ▶ The system involves anchoring the mounting brackets to the wall and at the floor.
- ▶ The unit with lower flap door is available with the door interior in bonded hide leather in Molteni range colours.

**The flap door cannot be considered a worktop, but only a surface on which to place lightweight materials.**

- ▶ The storage units only come with W 83,1 cm.

## Compositional wall fixing diagram

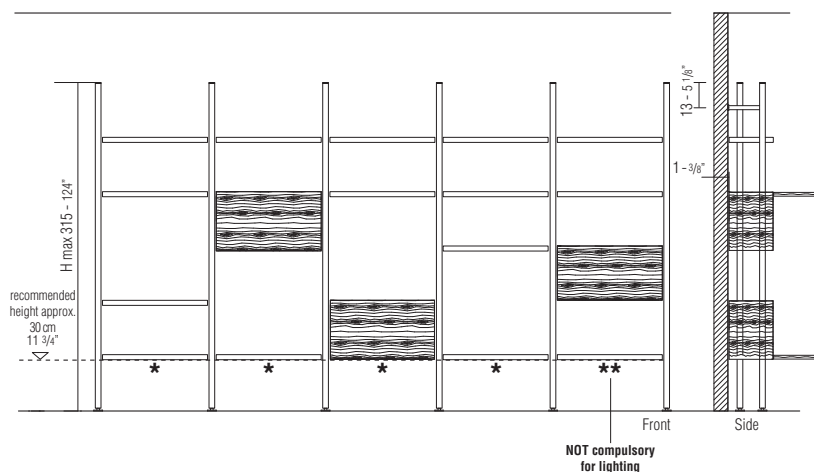

- ★ Compositions with lighting are required to have each module approximately 30 cm above the ground:
    - One shelf with aluminium frame and wood insert (wood or lacquered).
    - Or a decoder unit, a drawer unit or a unit with lower flap door.
- All these elements must be aligned as they are required for the electrical connection.

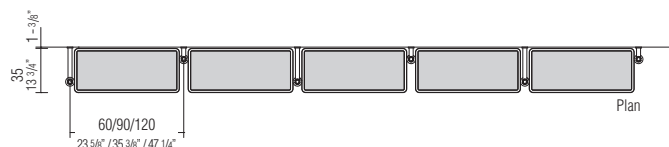

## Mounting bracket positioning

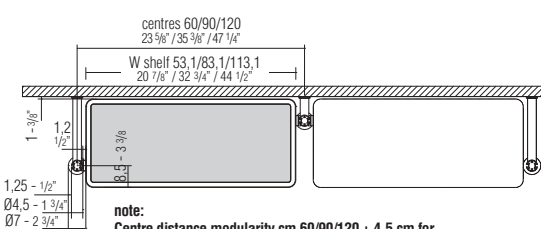
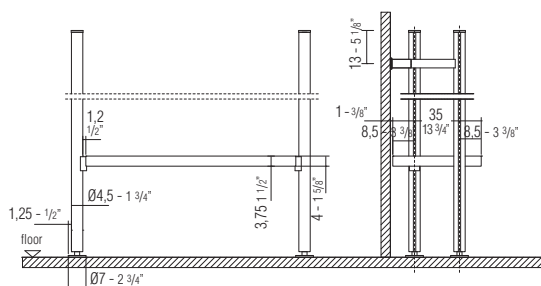
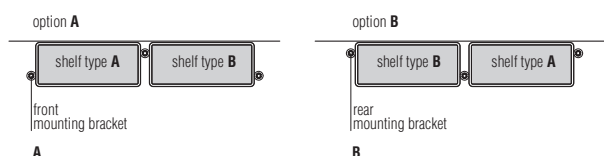

**note:**  
Centre distance modularity cm 60/90/120 + 4,5 cm for finished dimension (lower foot protrusion cm 1,25)

## Shelf capacity with aluminium frame:

W 53,1 = Kg. 15

W 83,1 = Kg. 23

W 113,1 = Kg. 27

## Shelf capacity with solid wood frame:

W 53,1 = Kg. 9

W 83,1 = Kg. 15

Flap door capacity = kg. 4

Container interior capacity = kg. 8

Unit surface capacity = Kg. 15

## DATASHEET

REGISTERED  
DESIGN

2026



LED LIGHTING

Notes

When ordering, indicate the shelves with LED lighting.

Molteni & C

6—  
9

Example calculation for power supply unit

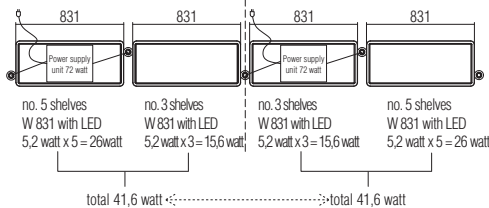
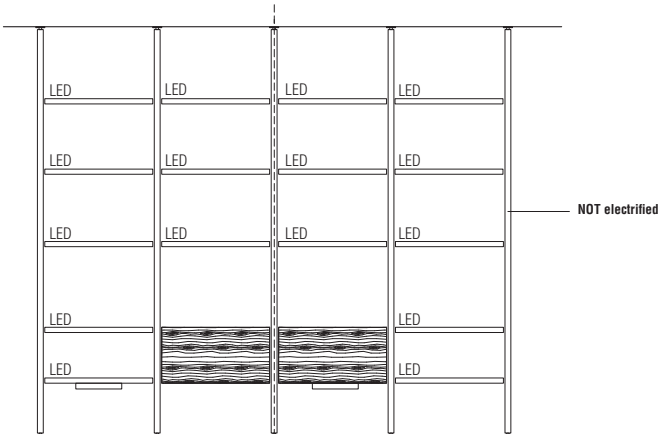
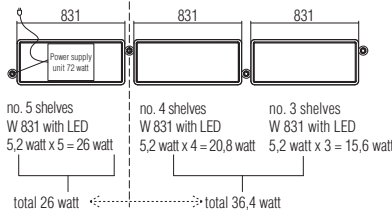
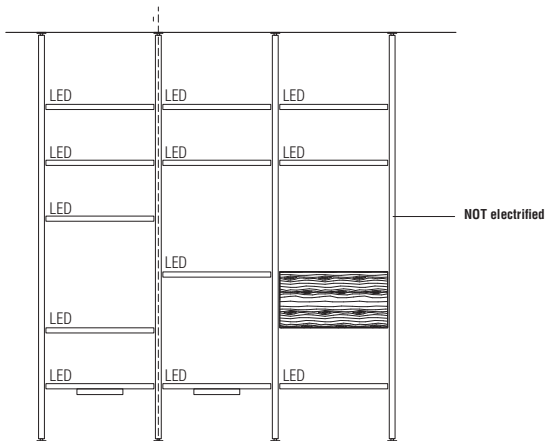

Lighting system consisting of:

- no. 3 mounting brackets with electrified cable duct
- no. 1 mounting bracket without electrified cable duct
- no. 12 shelves with LED lighting
- no. 1 power supply unit 72 watt

Lighting system consisting of:

- no. 4 mounting brackets with electrified cable duct
- no. 1 mounting bracket without electrified cable duct
- no. 12 shelves with LED lighting
- no. 2 power supply units 72 watt

DATASHEET

REGISTERED  
DESIGN

2026

DIMENSIONS

- The mounting bracket, H max 315, can be made to measure, at no extra cost.
  - Shelves with frames in slate, pewter colour, bronze and iris can be reduced in width at a supplementary cost each (with or without LED lighting). Minimum reduced shelf measurement 30 cm (centre distance of mounting brackets).
  - The mounting brackets are prepared for ceiling, floor, and wall fixing.
- The dealer is tasked with choosing the most suitable and safest fixing means for each specific situation.
- We recommend a scrupulous preliminary check of the structural state of the ceilings or walls before ordering and installing the Hector unit.

Mounting brackets

H max 315 - 124"  
Ø 4,5 - 1 3/4"

Ceiling



without electrified  
cable duct  
PFS031

with electrified  
cable duct  
PFS031K

Wall  
version A  
beam 25 - 9 7/8"

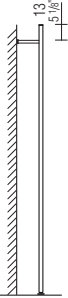

without electrified  
cable duct  
PFPA31

with electrified  
cable duct  
PFPA31K

Wall  
version B  
beam 7 - 2 3/4"

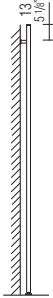

without electrified  
cable duct  
PFPB31

with electrified  
cable duct  
PFPB31K

Shelves  
frame slate

D 35 th 4  
D 13 3/4" th 1 5/8"

W 60 - 23 5/8"  
3,2 watt

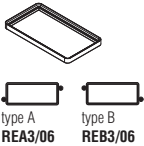

type A  
REA3/06

type B  
REB3/06

W 90 - 35 3/8"  
5,2 watt

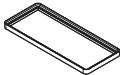

type A  
REA3/09

type B  
REB3/09

W 120 - 47 1/4"  
7,2 watt

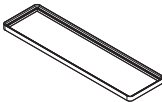

type A  
REA3/12

type B  
REB3/12

Shelves  
frame pewter colour/bronze/iris

D 35 th 4  
D 13 3/4" th 1 5/8"

W 60 - 23 5/8"  
3,2 watt



type A  
RIA3/06

type B  
RIB3/06

W 90 - 35 3/8"  
5,2 watt

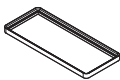

type A  
RIA3/09

type B  
RIB3/09

W 120 - 47 1/4"  
7,2 watt

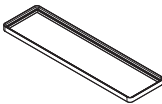

type A  
RIA3/12

type B  
RIB3/12

DIMENSIONS

- The shelf with a solid black oak frame is not available with LED lighting.
- The shelf with a solid black oak frame and containers cannot be reduced in any way.
- The flap door interior of the unit CARA03/09 - CARB03/09 is available with a bonded hide leather insert.

Shelves  
frame solid black oak

W 60 - 23 5/8"

W 90 - 35 3/8"

D 35 th 4  
D 13 3/4" th 1 5/8"

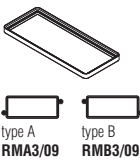
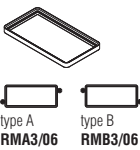

Container  
with lower flap door

W 90 - 35 3/8"

Optional internal shelf

W 77 D 25,5 th 2,2  
W 30 3/8" D 10" th 7/8"

D 35 H 46  
D 13 3/4" H 18 1/8"

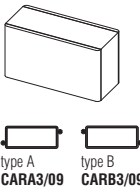

CRI3/09

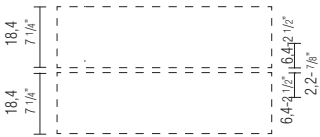

Drawer unit

W 90 - 35 3/8"

D 35 H 17,8  
D 13 3/4" H 7"

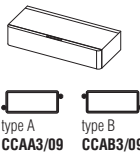

Container  
with upper flap door

W 90 - 35 3/8"

Optional internal shelf

W 77 D 25,5 th 2,2  
W 30 3/8" D 10" th 7/8"

D 35 H 46  
D 13 3/4" H 18 1/8"

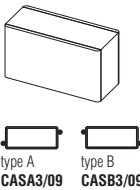

CRI3/09

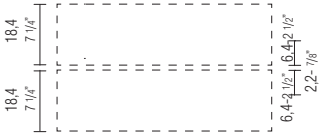

## DIMENSIONS

### TV signal transceiver system for decoder container unit

The Ø 1,8 sensor can be positioned as desired.

#### Decoder container unit with lower flap door

**D 35 H 17,8**  
**D 13 3/4" H 7"**

Only usable for  
wall compositions

**W 90 - 35 3/8"**



type A  
**CPDA3/09**

type B  
**CPDB3/09**

#### TV signal transceiver system with LED light for decoder container (transmission frequency from 30 to 38 KHz)

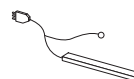

for 1 compartment  
**ETV1L**

#### TV support module

**D 9 H 50**  
**D 3 1/2" H 19 5/8"**

STANDARD VESA connection for TVs  
with screen sizes from 40" to 65".  
Mounting on free in height  
mounting bracket  
(rear mounting bracket  
recommended)

Included in the price mtl 0,50 profile  
for cable routing (see detail)

**W 50**  
**W 19 5/8**

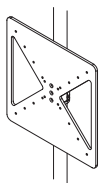

**EMPT1**

**Examples of use**  
TV support module  
Example 60 modules  
Recommended TVs: 40" - 43"

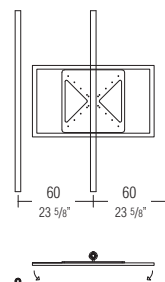

TV support module  
Example 90 modules  
TV screen types recommended : 49" - 65"

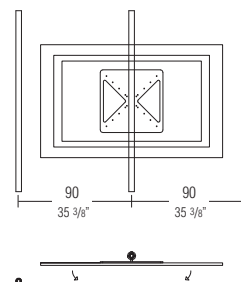

#### Cable passage behind the mounting bracket

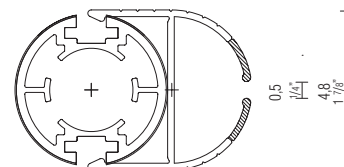

#### System components

**power supply unit 72 watt**  
with tray  
(positioned under the first left  
lower shelf)

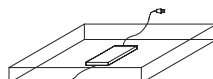

**EAL72**

**remote control kit**  
with dimmer  
(no. 1 for power supply unit)



**EKRR3**